

FRONT

84mm

50mm

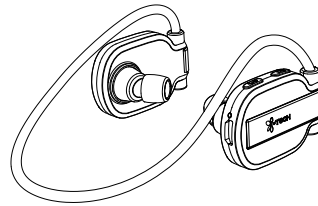

**MusicBAND 807**  
Bluetooth Headset

User Guide  
Bluetooth

**Contents**

Product Specifications ..... 4  
 MusicBand 807 Overview ..... 5  
 Getting Started ..... 6  
 Charging Your Headset ..... 6-8  
 Indicator Light ..... 7  
 Pairing Your Headset with a Bluetooth Mobile Phone ..... 8  
 Using Your Headset ..... 9-11  
 Resetting Your Headset / Removing the Pairing History ..... 12  
 Declaration of Conformity ..... 12

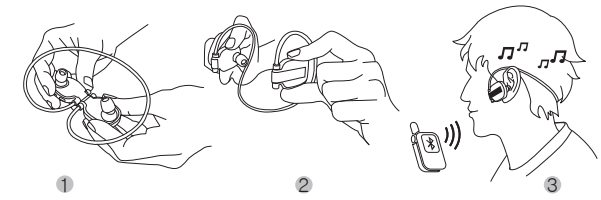

2

3

**Product Specifications**

Bluetooth Specification: V2.1 + EDR Class 2  
 Bluetooth Profiles Supported: HSP, HFR, A2DP, AVRCP  
 Range of Frequency: 2.4GHz spectrum  
 Nominal Charging Time: Within 3 hours  
 Talk Time\*: Up to 10 hours  
 Standby Time\*: Up to 350 hours  
 Dimensions: 56(L) x 15.5(W) x 11(T) mm / 2.2(L) x 0.6(W) x 0.4(T) inch  
 Weight: 23.5 grams / 0.83 ounces

\* may vary due to the user's habit, different modes of operation, and mobile phone settings.

4

**MusicBand 807 Overview**

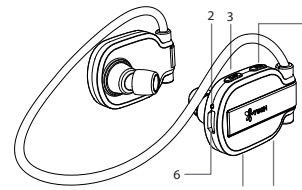

(fig.1)

1. Multi-function Button (MFB)
  - Power On / Off
  - Pair with mobile phone
  - Answer / End a call
  - Call waiting
  - Last number redial
2. Status Indicator
3. Play/Pause button
  - Play and Pause
  - Voice Dialing
4. Volume Up / Forward Button
5. Volume Down / Backward Button
6. Micro USB Charging Socket

5

**Getting Started**

To use your MusicBAND 807 Bluetooth headset ("headset"), please follow the steps below:  
 1. Ensure your headset is fully charged.  
 2. Pair your charged headset with a Bluetooth-enabled mobile phone.

**Charging Your Headset**

The headset comes with a built-in rechargeable battery. Prior to using the headset for the first time, it is recommended to fully charge the battery. Insert the charger's plug into the headset's USB charging socket and plug the mains charger to an AC wall outlet or plug to the PC/notebook.

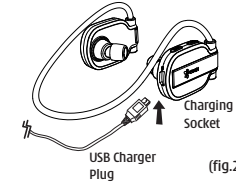

(fig.2)

**Use only the supplied charger / USB charging cable to charge the headset.**

6

BACK

**Charging Your Headset**

Indicator Light

Headset Status	Status Indicator Light
<ul style="list-style-type: none"> <li>• Standby</li> <li>• Charging (OFF MODE)</li> <li>• Fully charged (OFF MODE)</li> <li>• Low battery</li> <li>• Out of battery</li> <li>• Charging (STANDBY MODE)*</li> <li>• Fully charged (STANDBY MODE)*</li> <li>• Out of Range</li> </ul>	<ul style="list-style-type: none"> <li>• Flash blue</li> <li>• Solid red</li> <li>• The light turns off</li> <li>• Flash red with short beep every minute</li> <li>• The light turns off</li> <li>• Short blue and long red</li> <li>• Flash blue</li> <li>• Steady on red for 5 sec with long beep and then same as standby</li> </ul>

Use only the supplied charger / USB charging cable to charge the headset.

♦ Charging indication will be delayed for a few seconds if the headset has not been used for a long time or the battery is drained.

7

**Charging Your Headset**

- ♦ 3 hours are required to fully charge the headset.
- ♦ The headset remains in standby mode after being turned on.

\*Warning: Do not use the headset while it is connected to the charger.

**Pairing Your Headset with a Bluetooth Mobile Phone**

- 1) Ensure the headset is off.
- 2) To activate the pairing mode, press and hold the headset's MFB for 8 seconds without releasing your finger until its status indicator flashes blue and red alternately.
- 3) Activate your mobile phone's Bluetooth, search Bluetooth devices, select "MusicBAND 807" and enter the passcode "0000". When the pairing is completed, the headset's status indicator will flash blue rapidly 5 times and you can hear a long beep.

If the pairing cannot be completed within 3 minutes after the pairing mode has been activated, the headset's status indicator will flash blue rapidly 5 times and you can hear 3 short beeps. Then the headset turns off. Repeat steps 1 to 3 to pair both devices again.

8

**Using your headset**

Function	Button	Beep / Buzzer	Status indicator
POWER ON	Press and hold the MFB for 2 seconds	Short beep	Flash blue light 2 times
<b>When you turn on your headset for the first time, the headset proceeds into pairing mode, i.e. the status indicator flashes blue and red alternately, so that you can immediately pair it with your mobile phone.</b>			
POWER OFF	Press and hold the MFB for 2 seconds	Long beep	Flash red light twice
Incoming call		Ringtone through the earphone and buzzer ON	Blinking red
Answer / End a call	Press the MFB once		
Reject incoming call*	Press and hold the VOL for 2 seconds	Short beep	

9

**Using your headset (cont'd)**

Function	Button	Beep / Buzzer	Status indicator
Adjust Volume	Press VOL UP or VOL DOWN	Short beep at max. and min. volume	
Voice Dialing*	In Any Mode, press and hold Play/Pause for 2 seconds	short beep	
<b>Say the voice tag as soon as you hear the short beep and you must have recorded the voice tag into your mobile phone.</b>			
Last no. Redial*	In Any mode, double click MFB		
Call Transfer (headset to mobile phone)*	Press and hold the VOL for 2 seconds		
Call Transfer (mobile phone to headset)*	Press and hold the VOL for 2 seconds		

10

**Using your headset (cont'd)**

Function	Button	Beep / Buzzer	Status indicator
Call Waiting	Hold VOL UP for 2sec		
Play	Press Play/Pause once		
Pause	Press Play/Pause once		
Track forward	Hold VOL UP for 2sec		
Track backward	Hold VOL DOWN for 2sec		

\* Subject to mobile support

11

**Resetting Your Headset / Removing the Pairing History**

You may reset the headset to its default settings. Resetting will also remove the pairing history of your headset with the mobile phone.

1. During OFF mode, plug charging cable into the charging socket, then hold the VOL UP key until the headset sounds for 2 beeps.
2. Release the Volume key.
3. The status indicator will return charging mode and the headset is reset. You may also reset the headset to its default settings by hardware reset.

1. Plug charging cable into the charging socket
2. The headset is reset.

i.Tech Bluetooth headset is designed to work with Bluetooth devices. Due to large variability between different Bluetooth devices from different manufacturers, interoperability between the headset and all Bluetooth-enabled products is not guaranteed.

**Declaration of Conformity**

We, i.Tech Dynamic Limited, declare that the following product:

Product Name: i.Tech MusicBand 807

Model No.: CS1-B807-XX

is in conformity with the following essential requirements of Council Directive 1999/5/EC (referred to as R&TTE Directive): Article 3.1.a, 3.1.b and 3.2, and the product is manufactured in accordance with Annex II of the above directive.

A copy of the Declaration of Conformity can be found at <http://www.ittechdynamic.com>. S3J-51A807-01-F 12